

Why Us?

- > High Customer Satisfaction
- > Quick Turnaround
- > Cost Effectiveness
- > Quality & Reliability
- > Customer Relationship



Google
Customer Reviews
★★★★★
4.9 Out of 5



Facial Recognition Time Attendance & Access Control

AiFace-Jupiter



Wide Pose Angle
Acceptance



Wide Palm Pose Angle
Acceptance



Speedy
Recognition



Touchless for
Better Hygiene



Features

- Visible Light Facial Recognition
- Better hygiene with touchless biometric authentication
- Anti-spoofing algorithm against print attack (laser, color and B/W photos), videos attack and 3D mask attack
- Available card modules: 12.5 KHz EM card / 13.56MHz IC card (MF)
- Supplement light with adjustable brightness
- Multiple Verification Methods: Face / Fingerprint / Card / Password



An Official Channel Partner for eSSL

WhatsApp / Cell Number:
9655509003/4/5

Email Address:
smartbiosecuresystems@gmail.com

Our Services

BIOMETRICS-CCTV-DOOR ACCESS CONTROL-PARKING BARRIER-BOOM BARRIER
FLAP BARRIER-TURNSTILES-METAL DETECTORS-ANTI THEFT-PACKAGE SCANNER
TEMPERATURE DETECTION-GUARD PATROL-HOME LOCK-HOTEL LOCK-SAFE LOCKER
TIME & ATTENDANCE-PAYROLL-BULK SMS-ID CARD-STUDENT MANAGEMENT-HRMS
FIRE ALARM-DESKTOP-LAPTOP-PRINTERS-NETWORKING

Specifications

Display	5-inch Touch Screen
Face Capacity	6,000
Fingerprint Capacity	6,000 (Standard); 10,000 (Optional)
Card Capacity	10,000
Transactions	200,000
Operation System	Linux
Standard Functions	ID Card, ADMS, T9 Input, DST, Camera, 9-digit User ID, Access Levels, Groups, Anti- passback, Record Query, Tamper Switch Alarm, Multiple Verify Modes.
Hardware	900MHz Dual Core CPU, Memory 512MB RAM / 8G Flash, 2MP WDR Low Light Camera, Adjustable Light Brightness LED
Communication	TCP/IP, WiFi (Optional), Wiegand input / output, RS485
Access Control Interface	3rd Party Electric Lock, Door Sensor, Exit Button, Alarm output, Auxiliary Input
Optional Function	13.56MHz IC Card (MF)
Facial Recognition Speed	≤1s
Biometrics Algorithms	Face V5.8 & Finger V10.0 & Palm V12.0
Power Supply	12V 3A
Operating Humidity	10% - 90%
Operating Temperature	-10°C ~ 45°C (14°F ~ 113°F)
Dimensions (W*H*D)	134.93 * 166.93 * 21.5 (mm)
Supported Softwares	eTimetracklite

Configuration

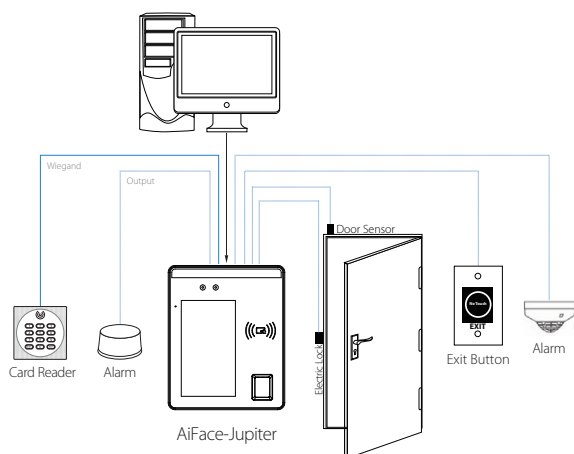

Dimensions (mm)

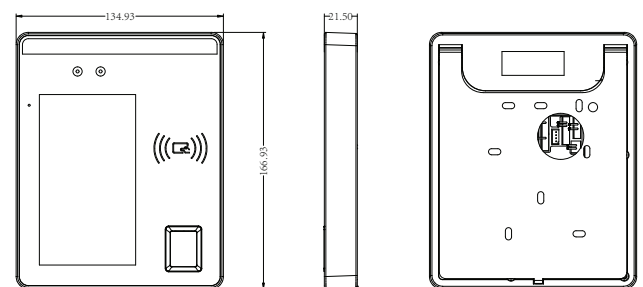

Disclaimer: Brief specifications are mentioned here. Specifications may change without prior notice. Customers are advised to check with us before purchase. Actual product may differ slightly to that depicted for ongoing product development

Visit Us at: www.esslsecurity.com

Our HAPPY Customers

www.smartbiosecureystems.com

9655509003 / 4 / 5



1000+ Happy Customers
Dedicated Support

Kind Regards  **SMART BIOSECURE SYSTEMS**
MORE INTELLIGENT. MORE SECURE.

Support 

Products 

Contact Us!
Cell: 96555 09003 / 4 / 5
e-Mail: smartbiosecureystems@gmail.com
www.smartbiosecureystems.com

Authorized Channel Partner for eSSL, Biomax, ZK Teco, Real Time

Biometrics Access Control Turnstiles Metal Detector Baggage Scanner Parking Barrier Smart Lock AM System Bulk SMS ID Card SPYCAMERA HRMS

Address: 32, Karnan St, AA-2, Ground Floor, Mogappair West, Chennai - 600037.

We do Sale • Support • Service and Repair for all locations in India.