



An Official Channel Partner for eSSL

WhatsApp / Cell Number:  
9655509003/4/5

Email Address:  
smartbiosecuresystems@gmail.com



# AiFace-Pluto

Linux-Based Hybrid-Biometric Access Control & Time and Attendance Terminal with Visible Light Facial Recognition



Proactive Facial Recognition



New Height of Anti-Spoofing



Speedy Recognition



Wide Pose Angle Acceptance



Touchless for Better Hygiene

## Features

- Visible Light Facial Recognition
- Anti-spoofing algorithm against print attack (laser, color and B/W photos), videos attack and 3D mask attack
- Available card modules: 125kHz ID card (EM) RFID S50/S70 IC card(13.56MHz) 1k/4k
- Supplement light with adjustable brightness

## 2 meters of recognition distance and extra wide angle recognition

The recognition distance has been greatly extended to 2 meters, which significantly improves the maximum traffic rate. While most of the algorithms only support +/-15° of detectable face angle, AiFace-Pluto doubles the detection angle in terms of head rotation and tilt to +/- 30°.

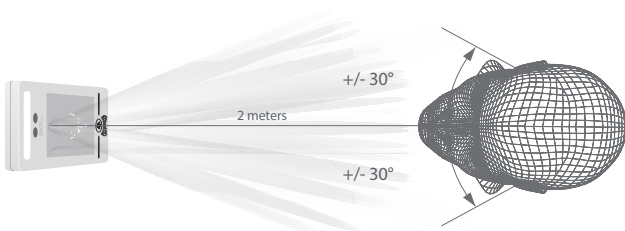
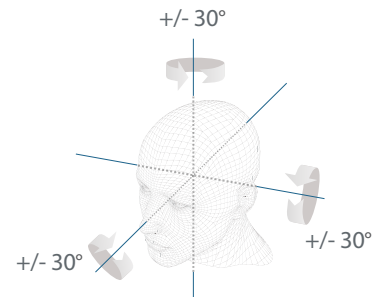

- > High Customer Satisfaction
- > Quick Turnaround
- > Cost Effectiveness
- > Quality & Reliability
- > Customer Relationship



Google Customer Reviews  
★★★★★  
4.9 Out of 5

# Specifications

Display	4" touch screen
Face Capacity	1,000
Card Capacity	1,000
Transactions	150,000
Operation System	Linux
Standard Functions	ID Card, ADMS, T9 Input, DST, Camera, 9-digit User ID, Access Levels, Groups, Holidays, Anti-passback, Record Query, Tamper Switch Alarm, Multiple Verification Methods
Hardware	900MHz Dual Core CPU; 512MB RAM / 512MBROM; 2MP Binocular Camera; Adjustable LED Supplement Lighting
Communication	TCP/IP, WiFi, Wiegand Input/Output, RS485
Access Control Interface	3rd-party Electric Lock, Door Sensor, Exit Button, Alarm Output, Auxiliary Input
Optional Function	RFID S50/S70 IC card (13.56MHz) 1k/4k
Facial Recognition Speed	≤1s
Biometrics Algorithms	Face V5.8 &
Power Supply	12V 3A
Working Humidity	10% ~ 90%
Working Temperature	0°C ~ 45°C (32°F ~ 113°F)
Dimensions (W*H*D)	72.94 * 157.94 * 23 (mm)
Net Weight	260g
Supported Software	eTimeTracklite

## Configuration

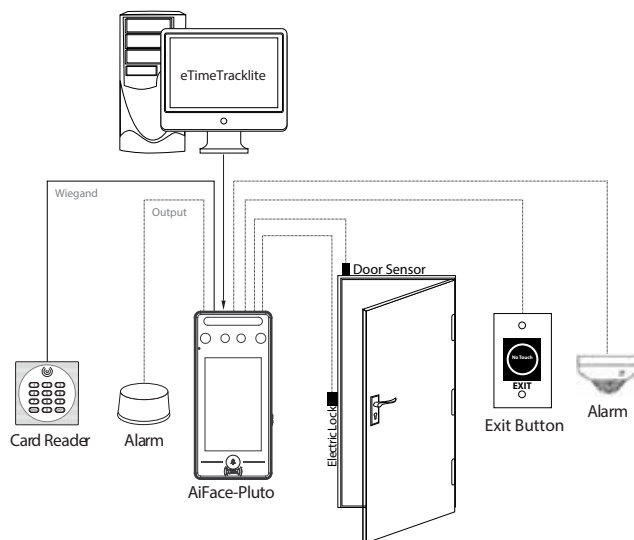

## Dimensions (mm)

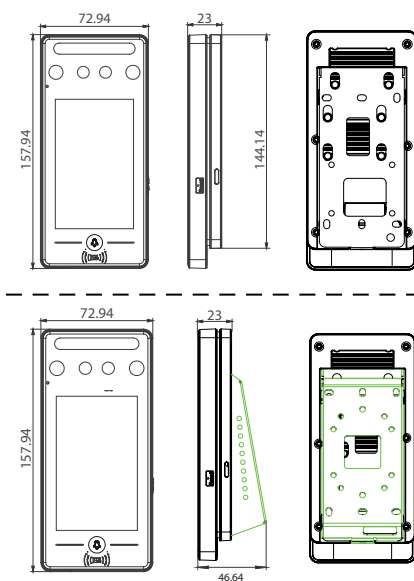

Disclaimer: Brief specifications are mentioned here. Specifications may change without prior notice. Customers are advised to check with us before purchase. Actual product may differ slightly to that depicted for ongoing product development

Visit Us at: [www.esslsecurity.com](http://www.esslsecurity.com)



# Our Services

**BIOMETRICS - CCTV - DOOR ACCESS CONTROL - PARKING BARRIER - BOOM BARRIER**  
**FLAP BARRIER - TURNSTILES - METAL DETECTORS - ANTI THEFT - PACKAGE SCANNER**  
**TEMPERATURE DETECTION - GUARD PATROL - HOME LOCK - HOTEL LOCK - SAFE LOCKER**  
**TIME & ATTENDANCE - PAYROLL - BULK SMS - ID CARD - STUDENT MANAGEMENT - HRMS**  
**FIRE ALARM - DESKTOP - LAPTOP - PRINTERS - NETWORKING**

## Our HAPPY Customers

www.smartbiosecuresystems.com

9655509003 / 4 / 5



**1000+** Happy Customers  
**Dedicated Support**

Kind Regards **SMART BIOSECURE SYSTEMS**  
MORE INTELLIGENT. MORE SECURE.

Support Products

Contact Us!  
Cell: 96555 09003 / 4 / 5  
e-Mail: smartbiosecuresystems@gmail.com  
www.smartbiosecuresystems.com

Authorized Channel Partner for **eSSL, Biomax, ZK Teco, Real Time**

Biometrics Access Control Turnstiles Metal Detector Baggage Scanner Parking Barrier Smart Lock AM System Bulk SMS ID Card/SPYCAMERA HRMS

Address: 32, Karnan St, AA-2, Ground Floor, Mogappair West, Chennai - 600037.  
We do Sale • Support • Service and Repair for all locations in India.